



RE/MAX

PROPERTY HUB



Britannic Park Yew Tree Road, Birmingham, B13 8NF

£299,999

A well presented and spacious second floor three bedroom apartment situated in the prestigious and popular Britannic Park development in Moseley. Excellent location close to Cannon Hill Park, Highbury Park, Moseley centre and Kings Heath High Street.

The property comprises of a spacious lounge with doors opening to the balcony, a modern fitted kitchen with built-in appliances comprising a fridge freezer, washing machine, dishwasher, oven and an electric four ring hob with a stainless steel extractor fan. There are three double bedrooms with bedroom one having an en-suite shower room, a built in double door wardrobe and a door opening to the balcony, bedroom two and three also having built in wardrobes.

The following excellent facilities are available to all the residents, indoor heated swimming pool, sauna, steam room, gym and a concierge service.

The property also has an allocated undercover parking space, gas fired central heating, double glazing, gated access for vehicles, separate gated access for pedestrians, an electronically operated video linked door opening system and a fob operated main door access system.

Floor Plan

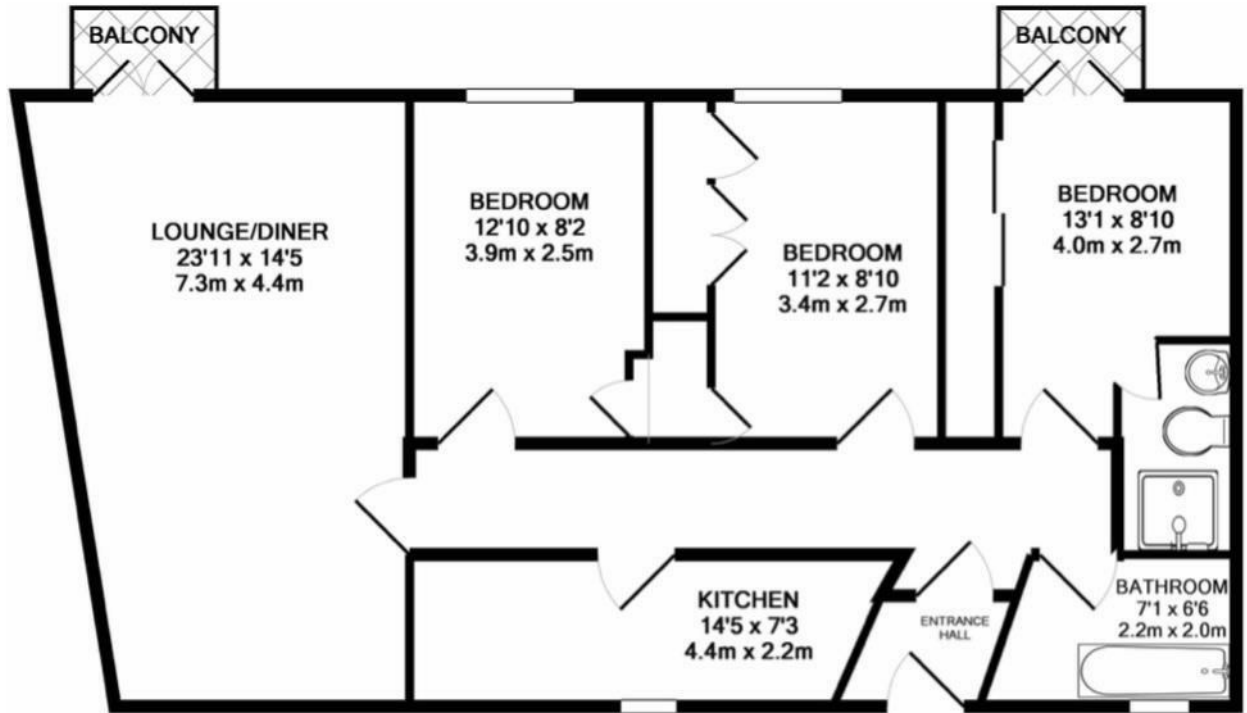

Area Map

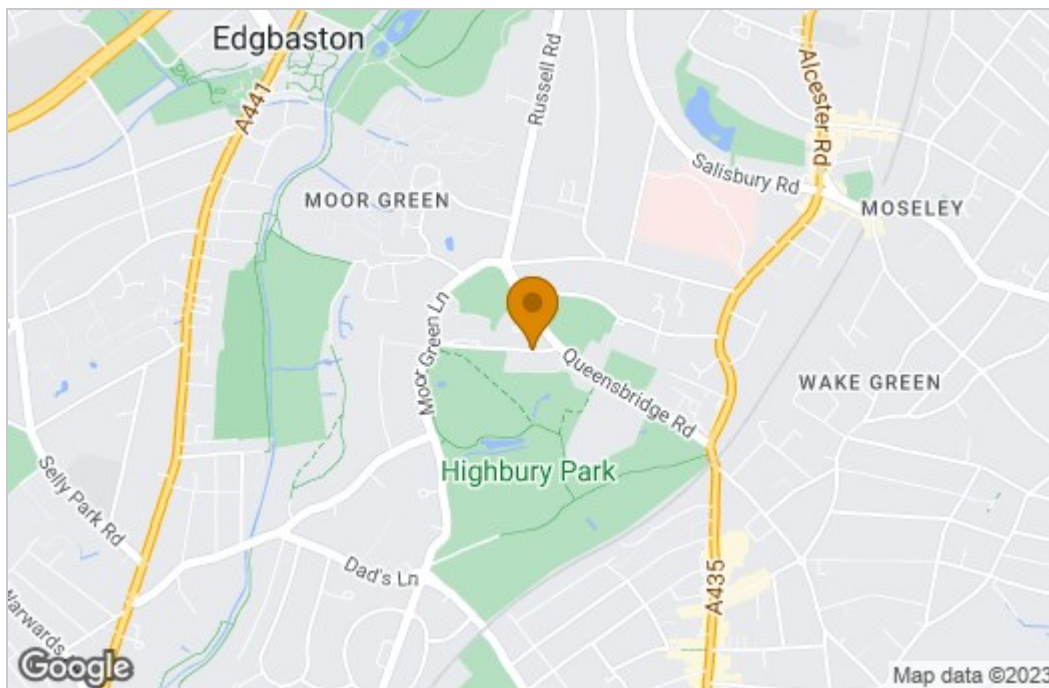

Energy Efficiency Graph

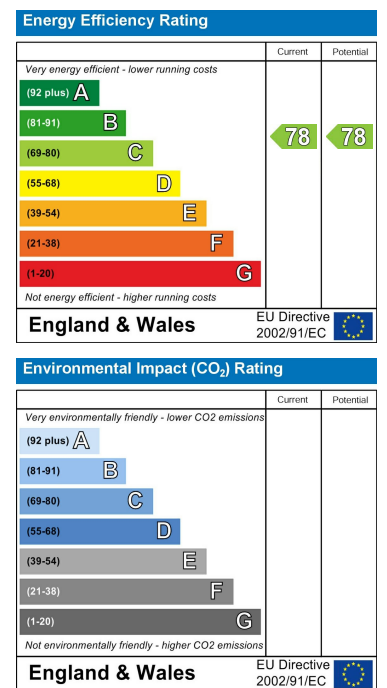

These particulars, whilst believed to be accurate are set out as a general outline only for guidance and do not constitute any part of an offer or contract. Intending purchasers should not rely on them as statements of representation of fact, but must satisfy themselves by inspection or otherwise as to their accuracy. No person in this firm's employment has the authority to make or give any representation or warranty in respect of the property.